

**S** **SINGER**® | SteamWorks™ Pro

Garment Steamer

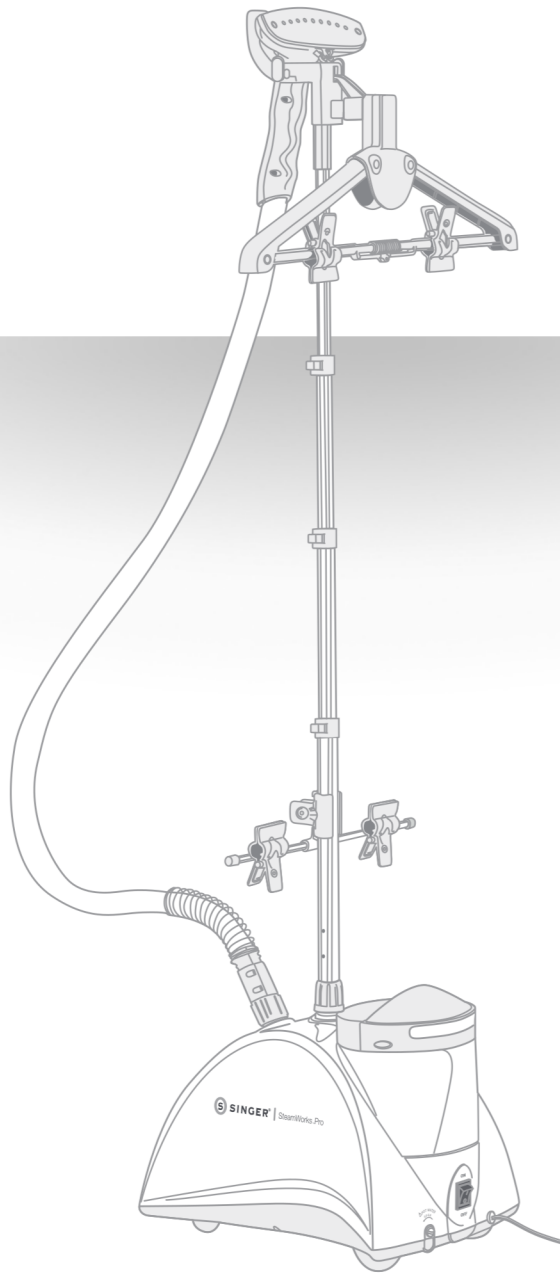

**SINGER**  
HOME ESSENTIALS™

instruction manual

# IMPORTANT SAFETY INSTRUCTIONS

1. Read all instructions before using this product.
2. Use this product only as described in this manual. Other uses not recommended may cause fire or electrical shock.
3. Do not immerse this product in water or any liquid; electric shock and injury could result.
4. Always unplug this appliance before coming into contact with liquid of any kind. This includes filling and emptying the water tank.
5. Close supervision is necessary when the appliance is used near children.
6. Do not leave this appliance unattended while it is in operation.
7. This appliance operates using high heat and steam that can cause burns to skin. Use caution around the Steam Head.
8. Do not touch the hot metal parts, hot water or steam to avoid burns.
9. Do not operate the steamer without filling the water reservoir. Always check the water level before and during operation.
10. Do not lay the hose on the ground or wind it.
11. Do not direct steam at people or animals.
12. Do not steam clothing while it is being worn.
13. Do not pour water directly into the reservoir. Pour water only into the water tank.
14. Turn the appliance OFF and let cool before changing Steam Head attachments to avoid burns.
15. The use of accessories or attachments not provided by SINGER Home Essentials may result in fire, electric shock, or injury.
16. Never insert any objects into the tank or hose.
17. Keep the hose and steam head elevated above the tank.
18. Steam only in a vertical motion. Never use this appliance in a horizontal position.
19. Allow the appliance to cool completely for at least 30 minutes and drain the water tank and water reservoir before storing.
20. Move the appliance by grasping the telescopic pole. Do not force the casters if they are stuck. Turn off the unit, cool completely, drain the water tank and water reservoir before inspecting the casters.
21. Unplug the unit from the outlet when not in use, when moving unit from one location to another, and before cleaning.
22. Do not place the unit or any parts near an open flame, cooking or other heating appliance.
23. If the cord becomes damaged or the appliance has been dropped or damaged, do not operate the product.
24. To avoid the risk of electrical shock, do not disassemble the steamer. Ship it to the nearest authorized SINGER-approved service center for examination and repair. Incorrect reassembly or repair can cause a risk of fire, electric shock, or injury while the appliance is in use.
25. No detergent can be added into the water tank or it will cause damage. Distilled or de-mineralized water is recommended.
26. Use this appliance indoors only.

## SPECIAL INSTRUCTIONS:

To avoid a circuit overload, do not operate another high-wattage appliance on the same circuit. If an extension cord is absolutely necessary, a 15-amp cord should be used. Cords rated with less amperage may overheat. Use care to arrange the cord so that it cannot be pulled or tripped over.

## SAVE THESE INSTRUCTIONS

FOR HOUSEHOLD USE ONLY

Thank you for purchasing a SINGER Home Essentials product. For over 150 years, we've been in homes around the globe providing expert garment care with quality, durable tools to keep your garments and fabrics looking fresh.

## GETTING TO KNOW YOUR GARMENT STEAMER

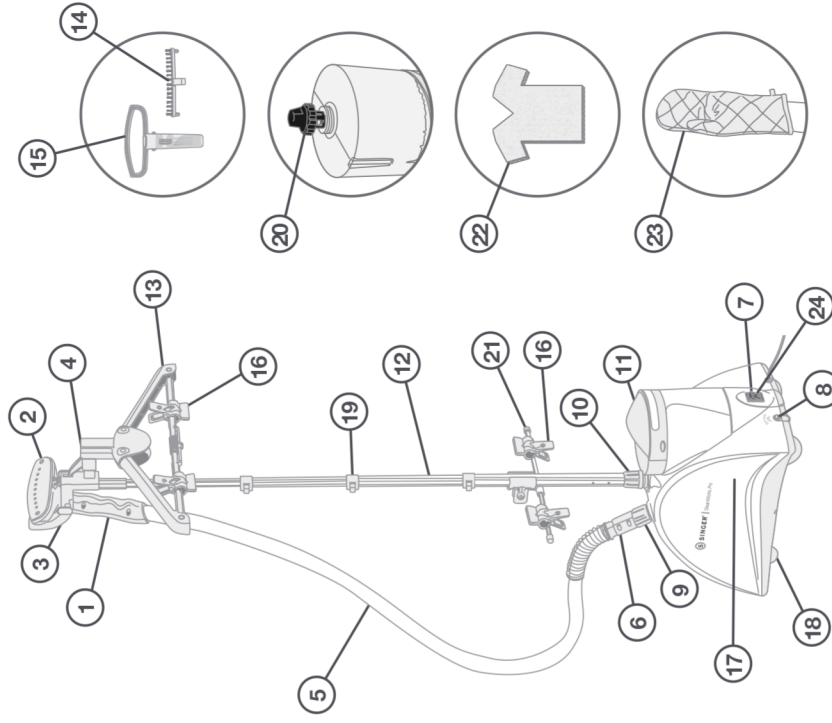

- |                             |                       |                             |
|-----------------------------|-----------------------|-----------------------------|
| 1. Handle                   | 9. Hose Base          | 17. Water Reservoir         |
| 2. Steam Head               | 10. Pole Base         | 18. Caster Wheel System     |
| 3. Steam Head Hanger        | 11. Water Tank        | 19. Pole Clips              |
| 4. Clothes Hanger Hook      | 12. Telescopic Pole   | 20. Valve Cap               |
| 5. Flexible Cool Touch Hose | 13. Rotating Hanger   | 21. Garment Clip Bar        |
| 6. Hose Connector           | 14. Fabric Brush      | 22. Handheld Steaming Board |
| 7. On/Off Switch            | 15. Crease Attachment | 23. Protective Glove        |
| 8. Drain Plug               | 16. Garment Clips     | 24. Power Indicator Light   |

**TECHNICAL SPECIFICATIONS:** Voltage: 120V, 60 Hz Power: 1500 Watts

## ASSEMBLY

### Assembling Your Steamer

- Remove all packaging.
- Place the steamer base on the floor and remove the Water Tank.
- Insert the Telescopic Pole into the Pole Base and twist the ring clockwise to lock.
- Connect the Clothes Hanger Hook to the top of the Telescopic Pole as shown.
- Expand the Telescopic Pole by unlocking the clips and fully extending the pole. Lock clips to secure.
- Attach the Cool Touch Hose by pushing the hose onto the Hose Base and turning 1/4 turn clockwise to lock.
- Hang the Steam Head on the Steam Head Hanger.

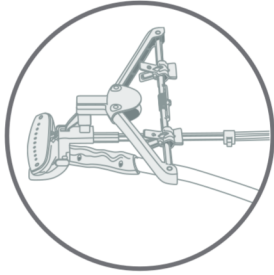
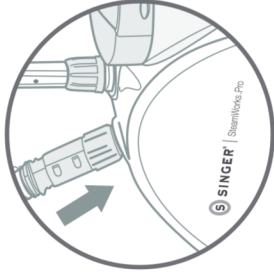
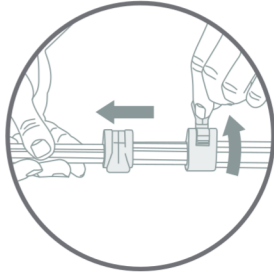
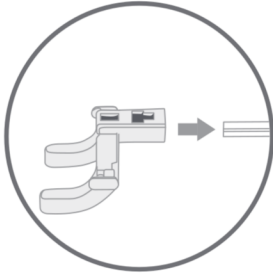
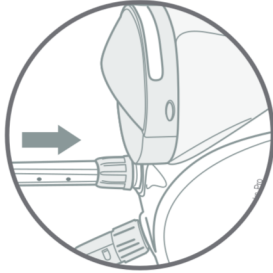
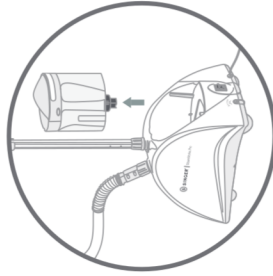

**WARNING:**

ALWAYS HANG THE STEAM HEAD ON THE STEAM HEAD HANGER WHEN NOT IN USE TO PREVENT INJURY AND SURFACE DAMAGE. MAKE SURE THE TELESCOPIC POLE IS FULLY EXTENDED DURING USE TO ENSURE A SMOOTH STEAM FLOW THROUGH THE HOSE. DO NOT PULL THE HOSE WITH EXCESSIVE FORCE OR MOVE IT BY PULLING ON THE HOSE. DAMAGE OR INJURY MAY RESULT.

### Crease Attachment Assembly and Use

- Turn the steamer off and wait until there is no steam coming from the Steam Head. And it is completely cool to the touch.
- Connect the flute of the Crease Attachment to the pegs at the bottom of the Steam Head.
- Push the Crease Attachment into place gently until it clicks.
- To use, place the fabric between the Steam Head and the Crease Attachment to create the crease. Move the Steam Head in a vertical motion to press the crease.

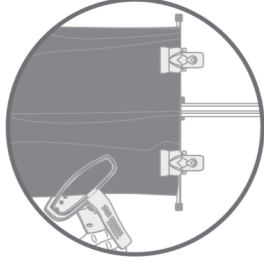
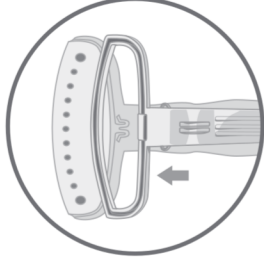

### Fabric Brush Assembly and Use

- Turn the steamer off and wait until there is no steam coming from the Steam Head and it is completely cool to the touch.
- Insert the pegs on the Fabric Brush into the holes in the Steam Head.
- Steam as usual, using the Fabric Brush to smooth stubborn wrinkles.

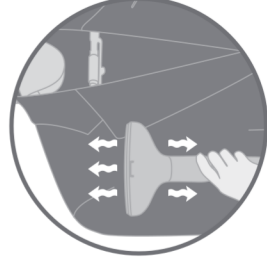
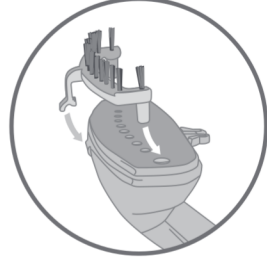

## Folding Hanger Assembly

- Secure the Steam Head Hanger assembly to the Telescopic Pole.
- Tilt the hook of the Rotating Hanger and insert it into the hole on the flat side of the Steam Head Hanger. Press gently to lock.
- Pull the arm of the Rotating Hanger up until the sides are completely extended.
- Lock the horizontal bar in place by aligning the dots on the bar.

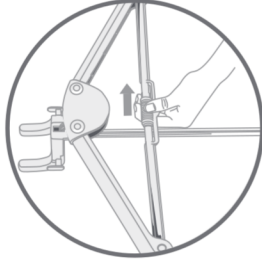
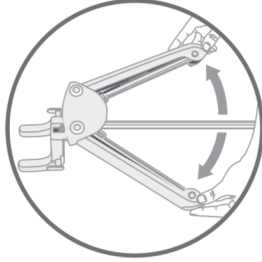
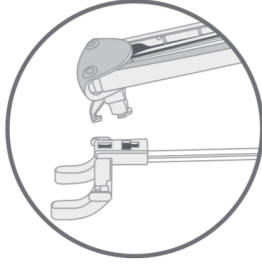

## Garment Clips Assembly and Use

- Snap the Garment Clips into the holes on the horizontal bar of the Folding Hanger.
- Clip the Garment Clip Bar to the bottom of the Telescopic Pole.
- To use, hang the garment from the top clips and secure with the bottom clips, pulling the garment taut to steam or crease.

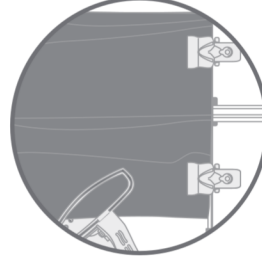
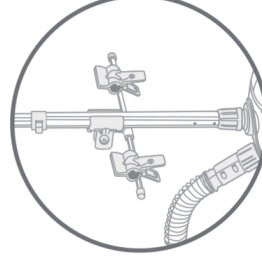
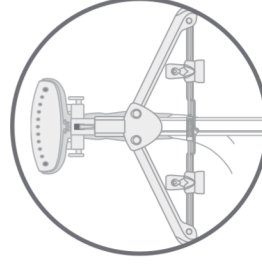

**WARNING:** ALWAYS TURN OFF THE STEAMER BEFORE ATTACHING ACCESSORIES TO AVOID INJURY.

## Filling the Water Tank

- Turn the steamer off and unplug it.
- Remove the Water Tank by pulling upward on the handle.
- Unscrew the Valve Cap from the Water Tank, fill the tank with cool water, and replace the Valve Cap. Do not use hot water. To prolong the life of your steamer we recommend using distilled or de-mineralized water.
- The tank holds 2.5 Liters of water.
- Insert the Water Tank into the base, making sure the plug on the bottom of the tank meets the post on the steamer base and fits securely in the cavity.

**NOTE:** Do not operate the steamer without water as this could cause damage to the unit.

Never use water with additives, including scents, starches, or fabric conditioners, as they can cause deposits to form in the steamer that can stain your clothing.

